

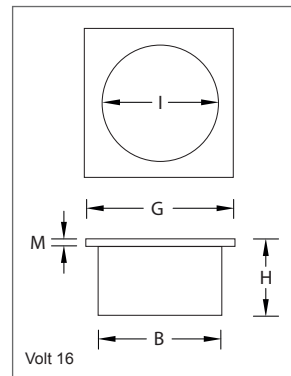

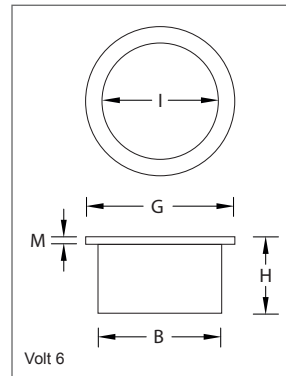

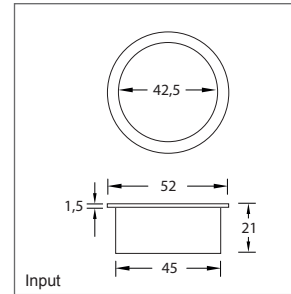

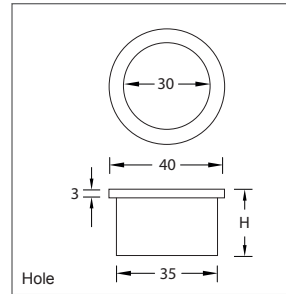

Design - Kabeldurchlässe Volt 6, Volt 16, Hole, Input
Werkstoff: Edelstahl, Aluminium

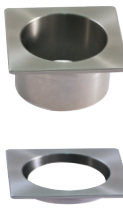
WEBCODE: CJMB Volt 6 WEBCODE: LVEF Hole
WEBCODE: SJQG Volt 16 WEBCODE: UOTC Input



Modell	Größe (G)	I	B	H	M	Bestell-Nr.	Bestell-Nr.	Bestell-Nr.
 Kabeldurchlass Volt 6, zum Einkleben.	25 mm	21 mm	23 mm	20 mm	1 mm	548.71.91	548.71.95	—
	30 mm	26 mm	28 mm	20 mm	1 mm	548.71.93	548.71.98	—
	30 mm	21 mm	25 mm	27 mm	2 mm	548.71.78	548.71.60	—
	35 mm	26 mm	30 mm	27 mm	2 mm	548.71.79	548.71.62	—
	40 mm	30 mm	35 mm	27 mm	2 mm	548.71.80	548.71.64	—
	45 mm	36 mm	40 mm	27 mm	2 mm	548.71.81	548.71.66	—
	55 mm	46 mm	50 mm	27 mm	2 mm	548.71.88	548.71.67	—
 Kabeldurchlass Volt 16, zum Einkleben.	60 mm	51 mm	55 mm	27 mm	2 mm	548.71.82	548.71.61	—
	40 mm	30 mm	35 mm	8 mm	2 mm	548.71.85	548.71.68	—
	30x30 mm	21 mm	25 mm	27 mm	2 mm	548.75.30	548.75.40	—
	35x35 mm	26 mm	30 mm	27 mm	2 mm	548.75.31	548.75.41	—
	40x40 mm	30 mm	35 mm	27 mm	2 mm	548.75.32	548.75.42	—
	45x45 mm	36 mm	40 mm	27 mm	2 mm	548.75.33	548.75.43	—
	55x55 mm	46 mm	50 mm	27 mm	2 mm	548.75.34	548.75.44	—
 Kabeldurchlass Hole, zum Einkleben.	60x60 mm	51 mm	55 mm	27 mm	2 mm	548.75.35	548.75.45	—
	40x40 mm	30 mm	35 mm	8 mm	2 mm	548.75.37	548.75.47	—
 Kabeldurchlass Hole, zum Einkleben.	40 mm	30 mm	35 mm	23 mm	3 mm	—	—	70.53.21
	40 mm	30 mm	35 mm	9 mm	3 mm	—	—	70.54.21
 Kabeldurchlass Input, zum Einkleben.	52 mm	42,5 mm	45 mm	21 mm	1,5 mm	—	—	70.50.21